

Mobile instructions

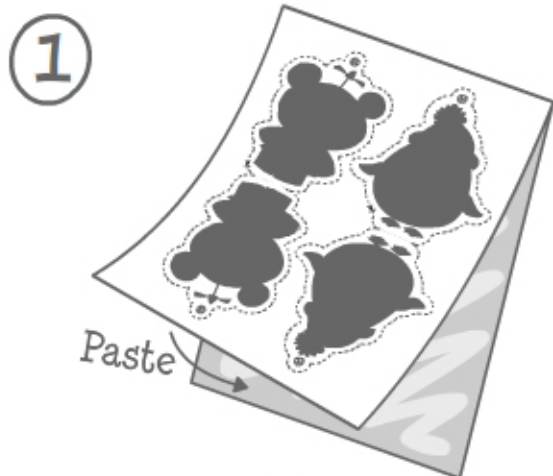

Glue each printed page to a thick piece of construction paper.



Use scissors to cut the characters and the two brackets out along the dotted line.

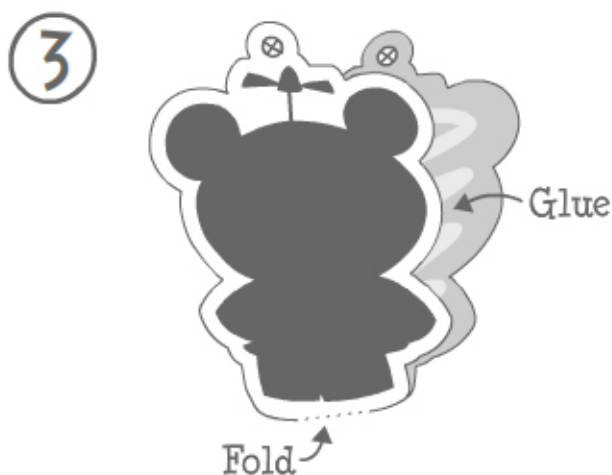

Fold the characters at the fold mark and glue the two sides together.

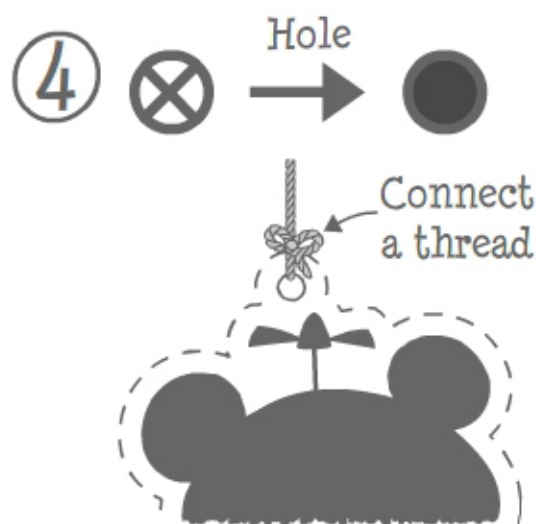

Make a hole in the top of each character with a hole punch and tie a long string to it.

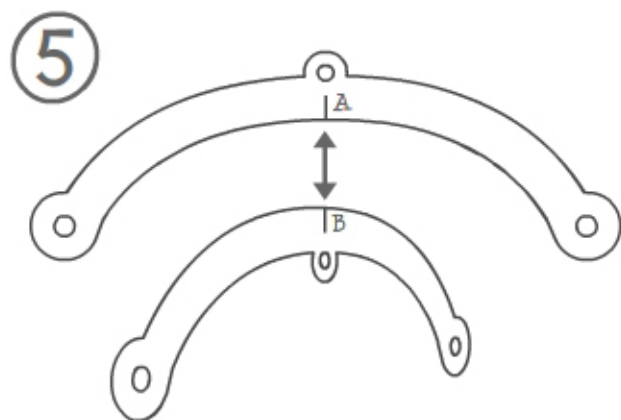

Position the two brackets so the slit in bracket A slides onto the slit in bracket B.

* Variation: You can use two chopsticks instead, positioning them perpendicular to each other to create a cross and glue them together at the joint.



Tie each character to the bracket four bracket ends using the string attached to each. Tie the flower character to the center of the bracket.

Caution - make sure to keep the mobile out of your baby's reach!

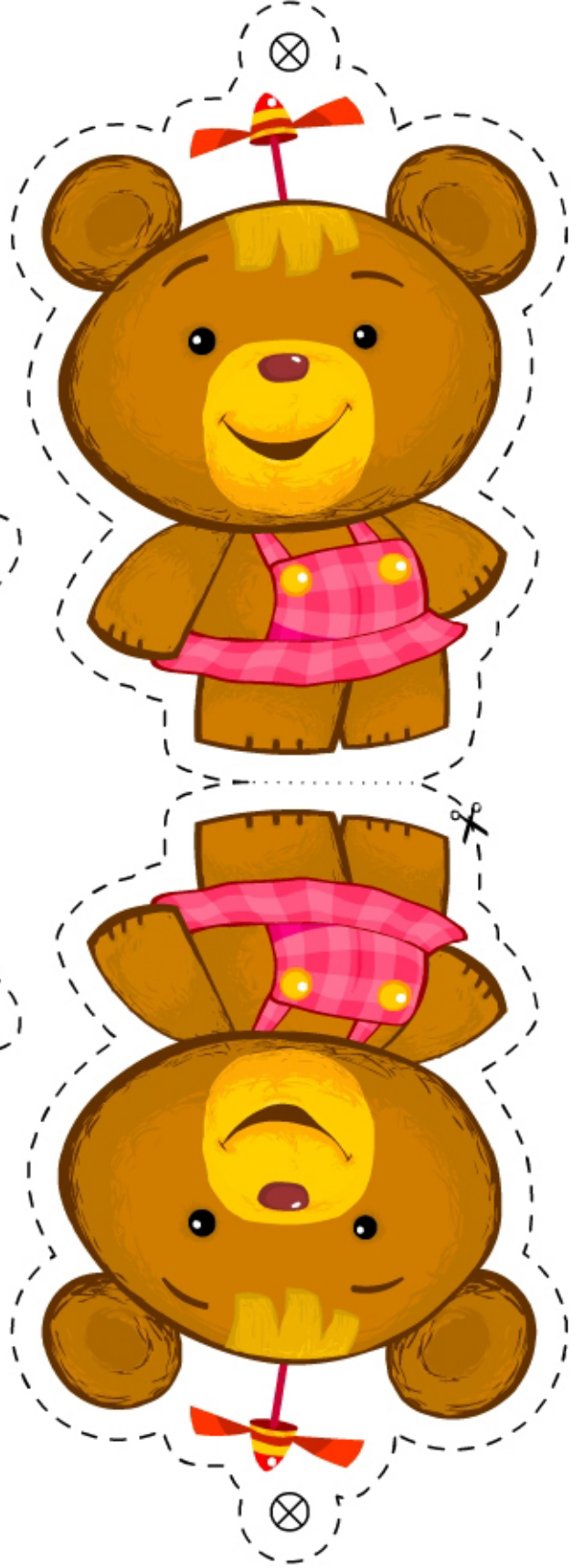
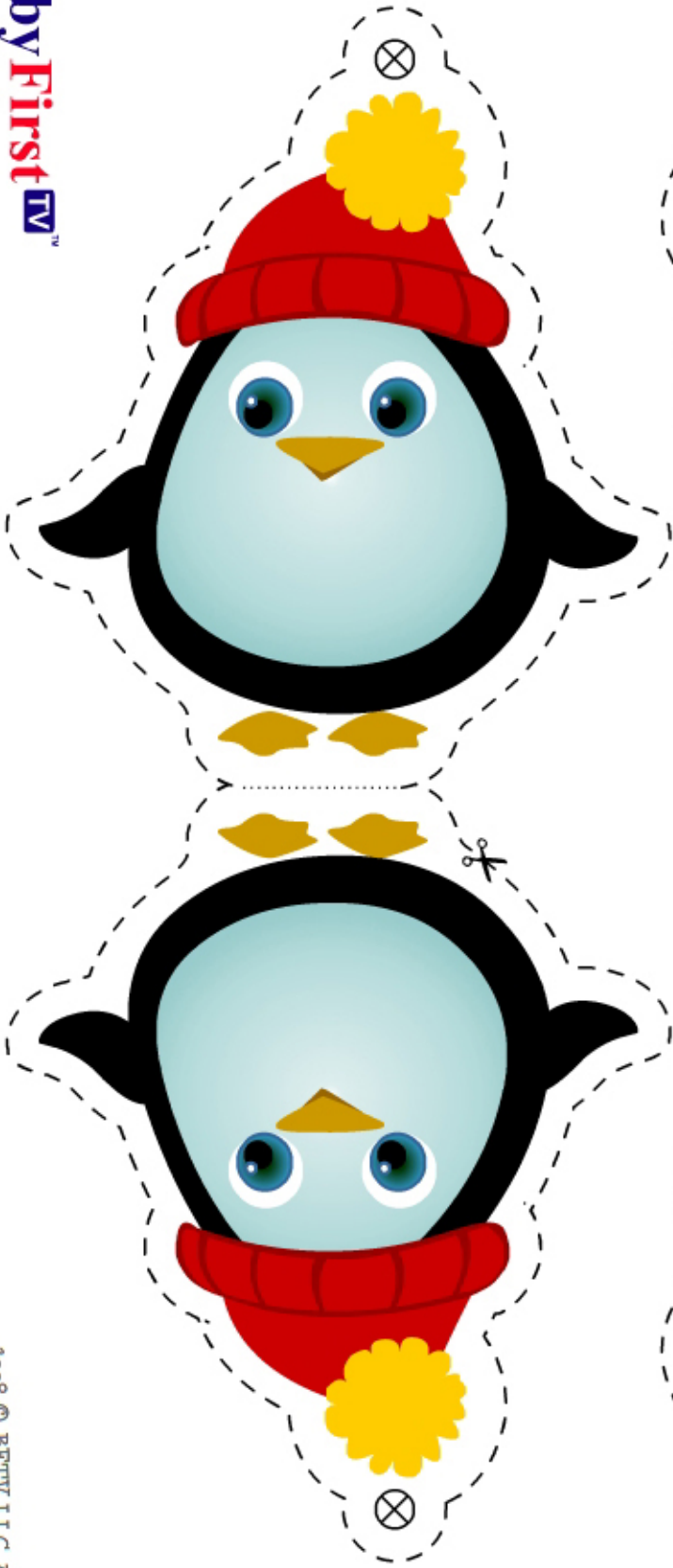



Baby First TV™
Watch your baby blossom



